

Integrity. Dedication. Professionalism.
MEDICAL OFFICE SPACE FOR LEASE

152 Cleopatra Drive, Ottawa



Medical Office for Lease | Ottawa South

Price: \$16.00/sf
OPC: \$16.08/sf

Suite 116 - 2,262 sf

CONTACT:

613-759-8383

leasing@districtrealty.com

Darren Clare

Director, Leasing & Investment Sales
Sales Representative

Medical office available in the Harmony Health Centre, conveniently located just off Merivale Road. Corner suite with reception area, two private washrooms, and several private examination rooms with sinks in most.

Well established medical centre with a coffee shop and parking lot on-site. Neighbouring tenants offer blood work, ultrasound, physiotherapy, and gynecology.

Quick access to a wide range of amenities and restaurants. Short drive to HWY 416 and 417.



1 152 Cleopatra Drive, Ottawa

District Realty Corporation Brokerage
districtrealty.com

The information as herewith enclosed has been obtained from sources we believe to be reliable, but we make no representation or warranties, express or implied, as to the accuracy of the information. All references to square footage and other information contained herein are approximate and subject to change. Prospective Purchasers/Tenants shall not construe the information as legal advice. All properties are subject to change or withdrawal without notice.





HIGHLIGHTS

- Corner suite clinic space
- Established medical centre
- Client parking lot and street parking
- Close to all amenities
- Population of approx. 118,335 within a 5 km radius

CONTACT:

613-759-8383

leasing@districtrealty.com

Darren Clare

Director, Leasing & Investment Sales
Sales Representative

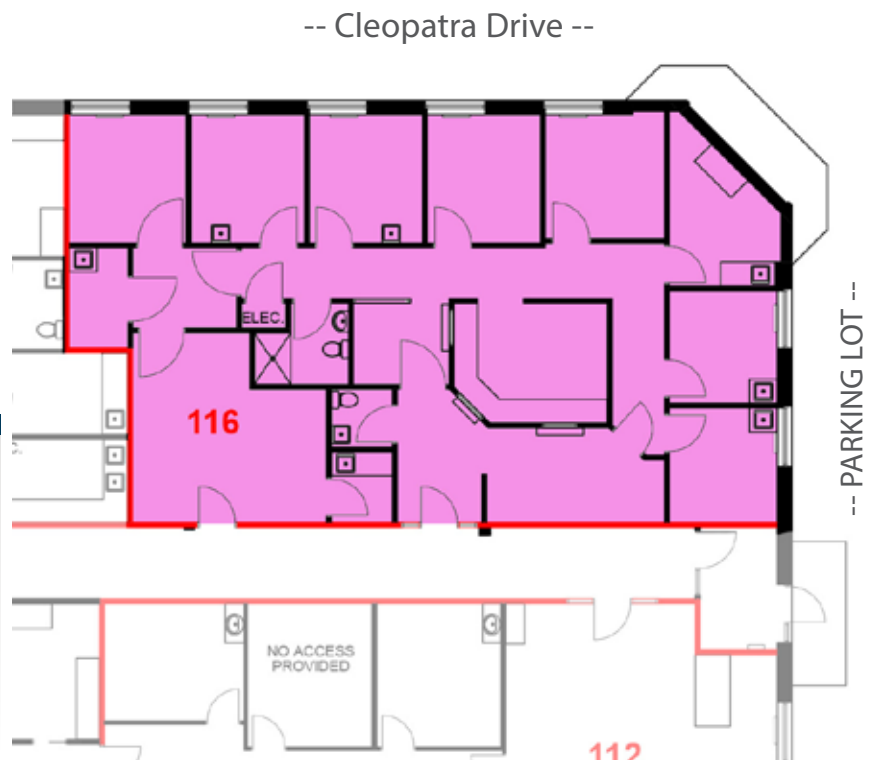

2 152 Cleopatra Drive, Ottawa

District Realty Corporation Brokerage
districtrealty.com



The information as herewith enclosed has been obtained from sources we believe to be reliable, but we make no representation or warranties, express or implied, as to the accuracy of the information. All references to square footage and other information contained herein are approximate and subject to change. Prospective Purchasers/Tenants shall not construe the information as legal advice. All properties are subject to change or withdrawal without notice.